

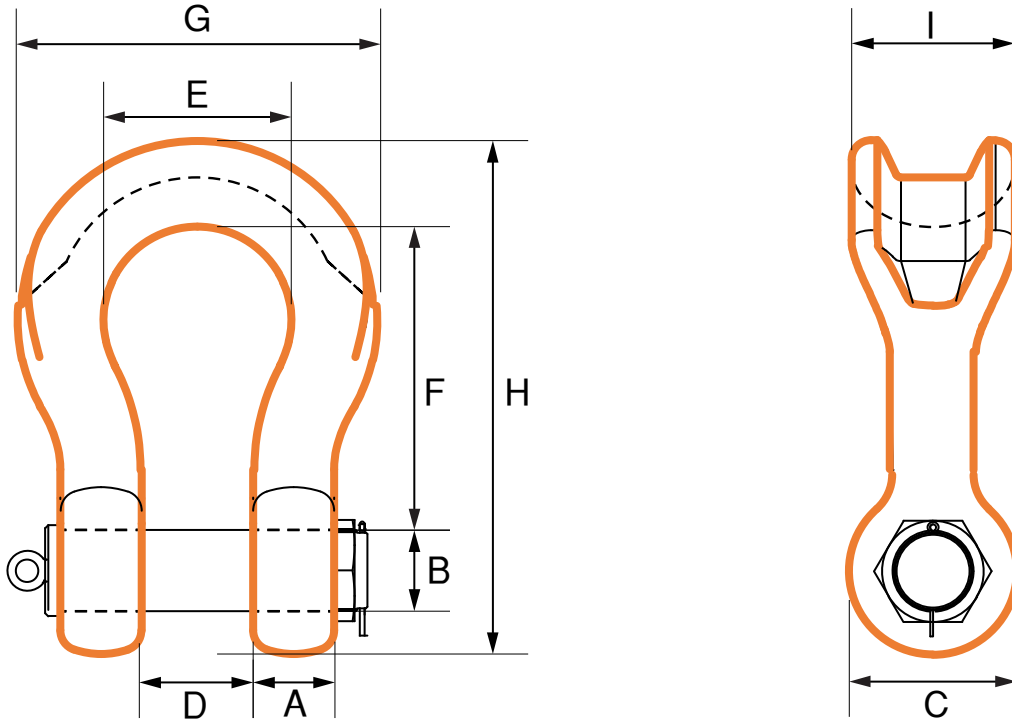

## Wide Body Shackle – Mooring Chain



WLL	Weight	A	B	C	D	E	F	G	H	I
30	14	35	44	90	65	128	180	209	292	80
40	21	45	51	109	84	140	200	235	331	97
55	33	65	56	130	90	160	250	288	400	115
75	53	75	70	150	110	185	300	334	485	120
125	84	85	80	165	140	220	370	380	583	150
150	115	90	95	200	150	250	400	429	638	170
200	183	105	105	225	160	275	480	484	755	205
250	255	120	120	240	180	300	550	540	850	240
300	368	140	134	280	195	350	600	628	947	265
400	571	160	160	330	230	370	620	689	1035	320
500	719	170	180	350	265	450	680	779	1125	340
600	960	180	200	405	290	490	720	849	1213	370
700	1350	210	215	465	320	540	780	957	1330	400
800	1400	220	230	465	345	555	800	975	1358	420
900	2100	235	250	480	370	585	850	1060	1450	440
1000	2200	235	270	530	400	615	850	1091	1490	460
1550	3300	275	320	610	485	680	980	1240	1745	580
1750	4700	310	360	660	500	700	1020	1326	2000	600
2000	4800	320	385	680	520	720	1060	1326	1913	620
2500	6300	340	430	760	520	740	1100	1400	2060	660
3000	6500	350	450	780	540	740	1100	1480	2060	680
3500	8000	370	465	830	560	760	1100	1560	2100	760
4000	8200	380	480	870	600	780	1100	1620	2100	800

Weight unit is Kilograms. All measurements in mm. Measurements, weights, and drawings, are based on industry standards. Deviation margins need to be taken in mind, this is your own responsibility and not from Castle Hills AS.