

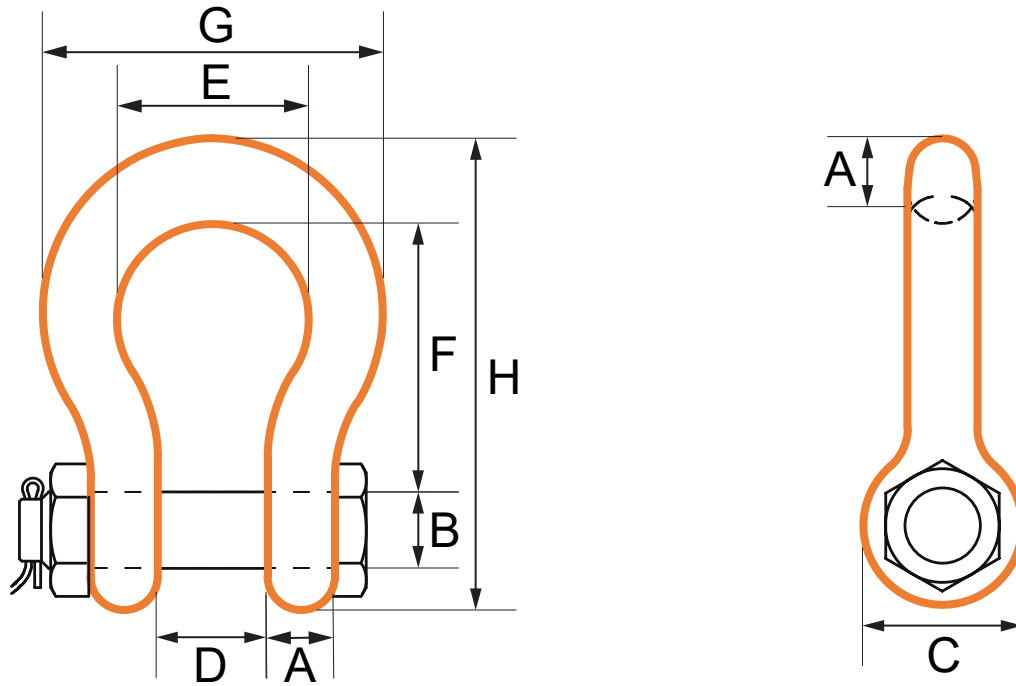

CROSBY G2130 SHACKLE – Mooring



WLL	Weight	A	B	C	D	E	F	G	H
0.33	0.03	4.9	6.4	14.2	9.7	15.2	22.4	24.9	37.3
0.5	0.05	6.4	7.9	15.5	11.9	19.8	28.7	32.5	46.7
0.75	0.1	7.9	9.7	19.1	13.5	21.3	31.0	37.3	53.0
1	0.15	9.7	11.2	23.1	16.8	26.2	36.6	45.2	63.0
1.5	0.22	11.2	12.7	26.9	19.1	29.5	42.9	51.5	74.0
2	0.36	12.7	16.0	30.2	20.6	33.3	47.8	58.5	83.5
3.25	0.62	16.0	19.1	38.1	26.9	42.9	60.5	74.5	106
4.75	1.23	19.1	22.4	46.0	31.8	51.0	71.5	89.0	126
6.5	1.79	22.4	25.4	53.0	36.6	58.0	84.0	102	148
8.5	2.28	25.4	28.7	60.5	42.9	68.5	95.5	119	167
9.5	3.75	28.7	31.8	68.5	46.0	74.0	108	131	190
12	5.31	31.8	35.1	76.0	51.5	82.5	119	146	210
13.5	7.18	35.1	38.1	84.0	57.0	92.0	133	162	233
17	8.62	38.1	41.4	92.0	60.5	98.5	146	175	254
25	15.4	44.5	51.0	106	73.0	127	178	225	313
35	23.7	51.0	57.0	122	82.5	146	197	253	348
55	44.6	66.5	70.0	145	105	184	267	327	453
85	70	76.0	82.5	165	127	200	330	365	546
120	120	92.0	95.5	203	133	229	372	419	626
150	153	104	108	229	140	254	368	468	653

Weight unit is Kilograms. All measurements in mm. Measurements, weights, and drawings, are based on industry standards. Deviation margins need to be taken in mind, this is your own responsibility and not from Castle Hills AS.